

High Performance Cool Air Intake



INSTALLATION INSTRUCTIONS

75-3031-1

CHEVROLET / GMC

**SILVERADO /SIERRA
2500 & 3500 HD
V8 6.0L**

QTY	PARTS LIST	QTY	PARTS LIST	QTY	PARTS LIST	TOOLS REQUIRED
1	3.5" - 3.75" x 2" Adapter	1	#56 Hose Clamp	4	SS Pan Head Screws	10mm Wrench
1	3.75" - 2" Adapter	1	Steel Ring Adapter	1	Air Filter	Flat-Head Screwdriver
1	Intake Tube	1	Ring Gasket			Phillips Screwdriver
1	Intake Box	4	#10-24 Screws			3/8" Socket or Nut Driver
1	Intake Lid	8	#10 Washers			
1	CARB Sticker	4	#10-24 Nylock Nuts			
1	Instruction Sheet	4	#10-24 Screws			
3	#60 Hose Clamps	4	Sealing Washers			

1. With engine off, disconnect the negative battery cable.
2. Loosen hose clamp connecting the OEM air intake to the throttle body.



- 5a. Lift up and towards the engine to remove OE air box.



8. Remove mass air sensor from OE air box.



3. Pry loose connector to radiator with a flat blade screwdriver & loosen clamp at box.

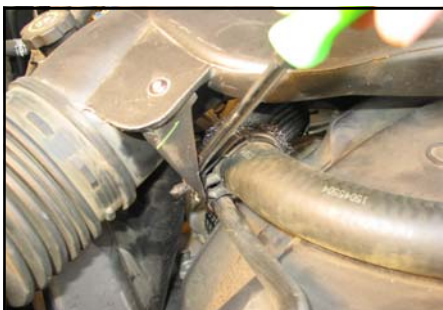

6. Remove and retain the 4 screws (2 long, 2 short) in bottom of air box tray.



9. Remove flange adapter from mass air sensor.



4. Remove OEM air intake tube

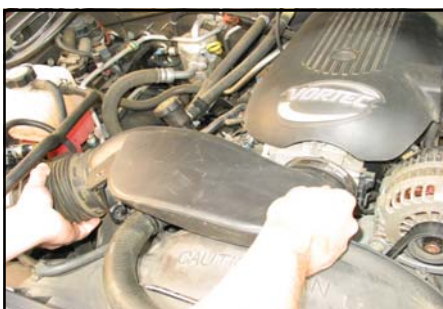

7. Assemble filter adaptor to box using hardware provided. Be sure to put gasket between box and adapter.



10. Install 3 3/4" x 2" flange adapter onto MAF (leave clamp loose).



5. Disconnect Mass air sensor.

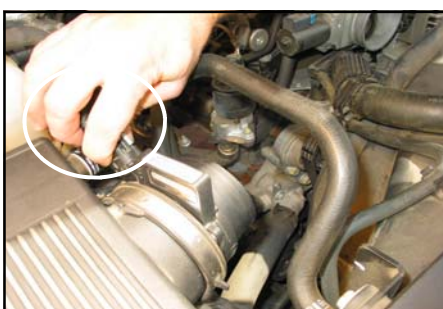

11. Set S&B High Performance Air Box in vehicle and secure using 4 (2 long, 2 short) of the screws you retained in Step 7.

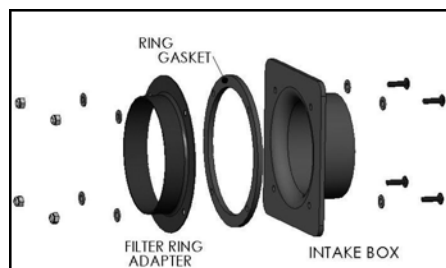
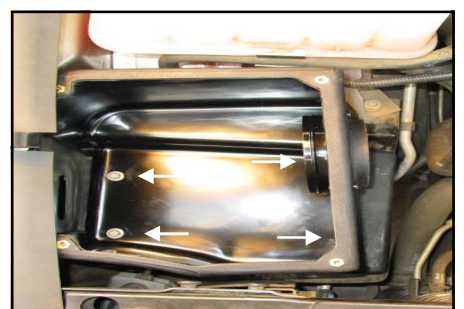

INSTALLATION INSTRUCTIONS (continued)

13. Attach mass air sensor to S&B air box and tighten both clamps.



17. Reconnect (plug in) mass air sensor.



14. Attach 3 3/4" to 3 1/2" tapered sleeve.



18. Install S&B High Performance Filter and tighten clamp.



15. Remove adapter from OEM intake tube and install on S&B air intake tube.



19. Attach clear lid with supplied screws and washers. Do not over tighten.



16. Install S&B air intake tube and tighten clamps on both ends.

20. Reconnect negative battery cable and ensure all connections are tight and positioned properly before starting vehicle.



PERFORMANCE TESTING

1. Engage parking brake and start your engine. To ensure that the system was installed properly, listen for abnormal noises. If an air leak is detected, re-inspect hoses and connections as they may need to be tightened.
2. S&B FILTERS RECOMMENDS THAT YOU KEEP YOUR OEM INTAKE SYSTEM IN THE EVENT IT IS REQUIRED IN THE FUTURE.
3. In order to maintain proper warranty, all connections and components must be checked periodically for realignment and to tighten all connections. Failure to do so will void your warranty.
4. Use only S&B Cleaning and Oil products to service your filter. Using another company's oil and cleaner products may void your warranty.

**Call (909) 947-0015
should you have any
questions or comments.**